



TECHNICAL DATA

4mm, 6mm, 10mm POLYCARBONATE MULTIWALL SHEET

Lotus Multiwall Sheets have a hollow core structure combining powerful physical properties and superior insulation. The sheets are ideal for non-corrosive Industrial roofing and many other applications in view of its high impact resistance and wide service temperature range.

LENGTH	11.80M
WIDTH	1.22M & 2.10M
THICKNESS TOLERANCE	$\pm 7\%$
LIGHT TRANSMISSION	CLEAR - 80%
HEAT TRANSFER CO-EFFICIENT (U VALUE)	3.8 W/M ² K
THERMAL EXPANSION	0.065MM/M °C
POSSIBLE HEAT AND MOISTURE EXPANSION	3MM/M
MAX. SERVICE TEMPERATURE	120°C
FLAMMABILITY (UL94)	V-2
SPECIFIC GRAVITY	1.2

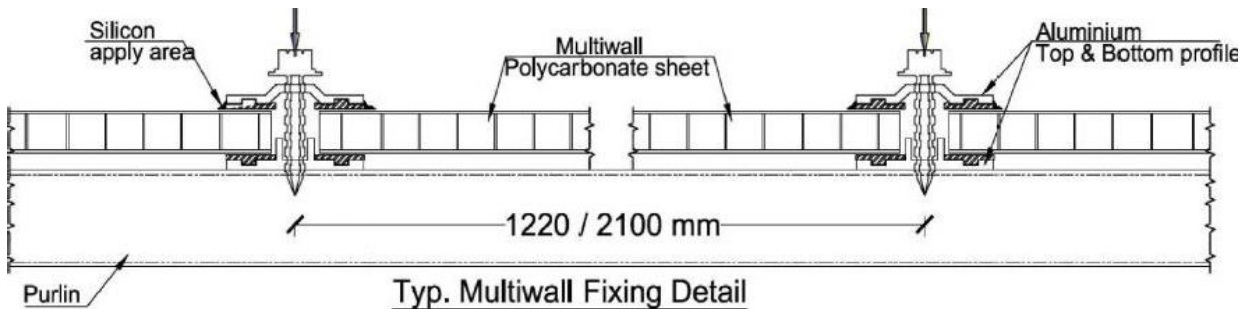

*Custom sizes can be made subject to MOQ

*Values are subject to change as per manufacturing standard.

*Manufactured conforming to ISO 7391-09-9 standard.